

Page 12 - Sperry positive feed bearing bracket parts

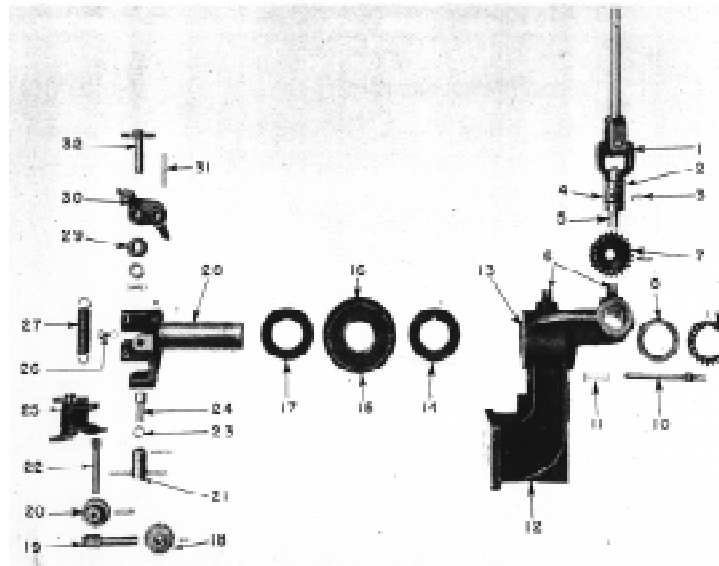

Ref No.	Skyview No.	Price (US Dollars)	Description
fig 20	CPfig20	1263.90	Positive feed
1	S136	25.00	Universal Joint
2	S134	10.00	Ball bearing
3	173144	1.50	Spacer screw
4	173133	19.50	Spacer
5	S112	7.00	Shaft, feed miter
6	pip1/8	4.50	Plug 1/8" pipe
7	S131	40.00	Gear miter driving
8	S126	1.50	Thrust washer 1 13/16 x 1/32
9	S130	45.00	Gear miter driven
10	S137	6.00	Feed plunger
11	S138	1.50	Feed plunger spring
12	76814	155.00	Positive Feed bearing bracket
13	S125	21.60	Needle bearing
14	190294	5.85	Slotted thrust washer
15	S124	75.00	Detent flange assembly
16	S123	50.00	Gear positive feed
17	173119	3.00	Thrust washer
18	S122	30.00	Feed pinion
19	S121	27.50	Feed worm
20	S120	30.00	Feed worm wheel
21	129595	55.75	Recarboning key
22	S119	25.00	Feed roller pinion
23	129596	.50	Recarboning cam washer
24	129594	36.75	Recarboning Cam
25	S117	37.50	Right hand feed roller bracket
26		1.75	recarboning cam screw .164-32 x 1/4
27	S115	1.50	Feed roller Bracket spring
28	S129	110.00	Positive feed bearing casting
29	S111	12.00	Feed roller
30	S116	37.50	Left hand feed roller bracket
31		1.75	Pin .188 x 1-1/8" SS
32	S112	7.00	Positive Feed shaft
32	S114	27.50	Positive feed roller gear

Copyright 1997 by National Event Marketing, Inc. Reproduction in whole or part is forbidden without the written consent of National Event Marketing, Inc.

All prices subject to change without notice

National Event Marketing, Inc. d.b.a. Skyview Company
2810 Thousand Oaks, Suite 237, San Antonio, Texas 78232
Web: www.sky-view.com E-Mail: sales@sky-view.com
Phone (USA): 800.562.8439 Phone (International): 011.95.210.681.8500