

Page 9 - Sperry complete head

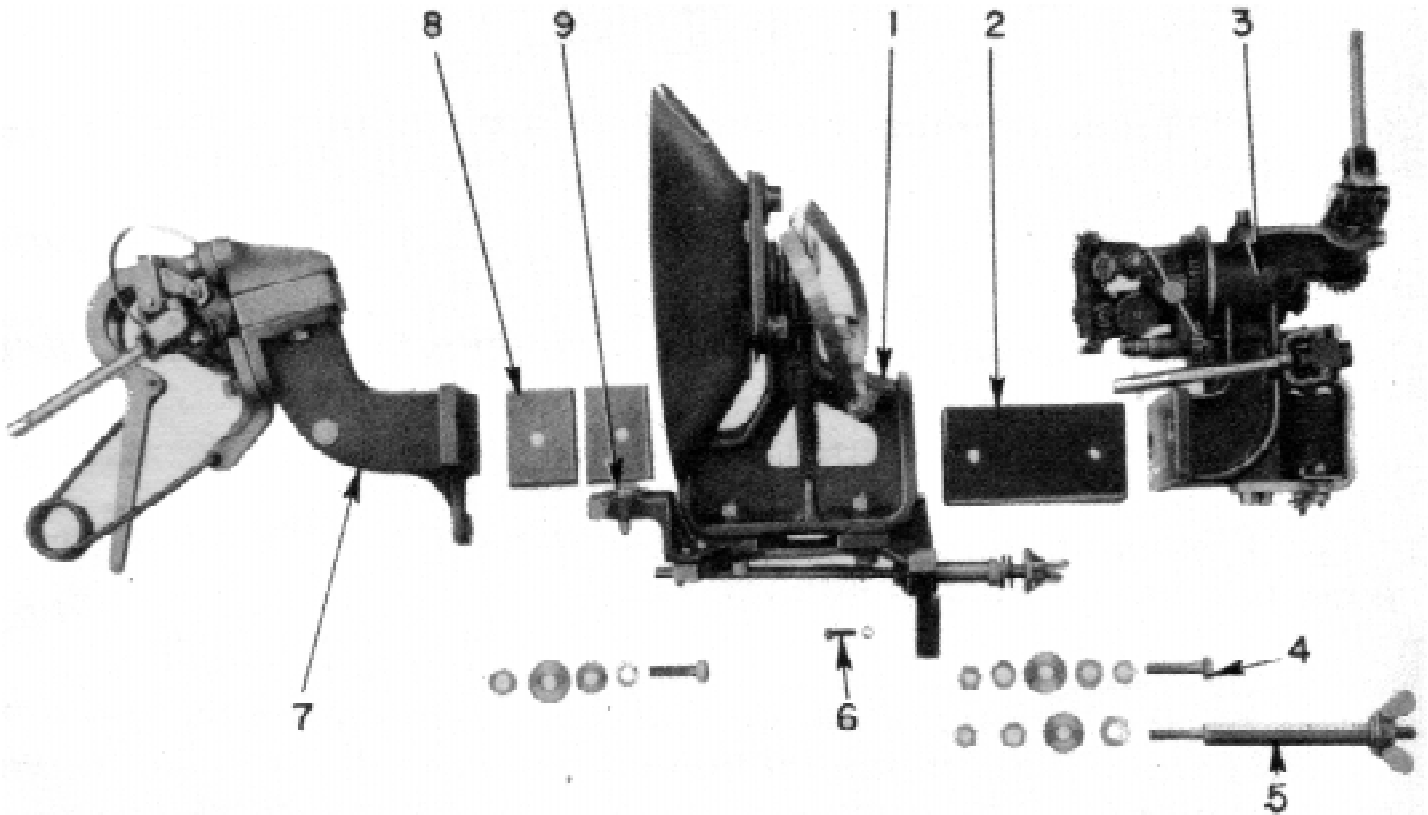

| Ref No. | Skyview No. | Price (US Dollars) | Description |
|---------|---------------|--------------------|--------------------------------------------------------------|
| | 644795-p | 3704.37 | Complete head assembly(specify "spread beam" or "std." base) |
| 1 | sperryposhead | 965.00 | Positive head assembly |
| 2 | S147 | 10.00 | Plate insulating |
| 3 | cpfig20 | 1263.87 | Positive feed bracket assembly |
| 4 | | .50 | 5/16-18 X 1 3/8" Hex Hd. S. S. |
| 5 | S143 | 20.00 | Terminal positive post |
| 6 | | .50 | screw 10-24*5/8" fil. Hd. S.S. |
| 7 | negheadsp | 568.50 | Negative head |
| 8 | S215 | 10.00 | Plate, negative insulating |

Copyright 1997 by National Event Marketing, Inc. Reproduction in whole or part is forbidden without the written consent of National Event Marketing, Inc.

All prices subject to change without notice

National Event Marketing, Inc. d.b.a. Skyview Company
2810 Thousand Oaks, Suite 237, San Antonio, Texas 78232
Web: www.sky-view.com E-Mail: sales@sky-view.com
Phone (USA): 800.562.8439 Phone (International): 011.95.210.681.8500