

**Page 8 - Ge miscellaneous parts**

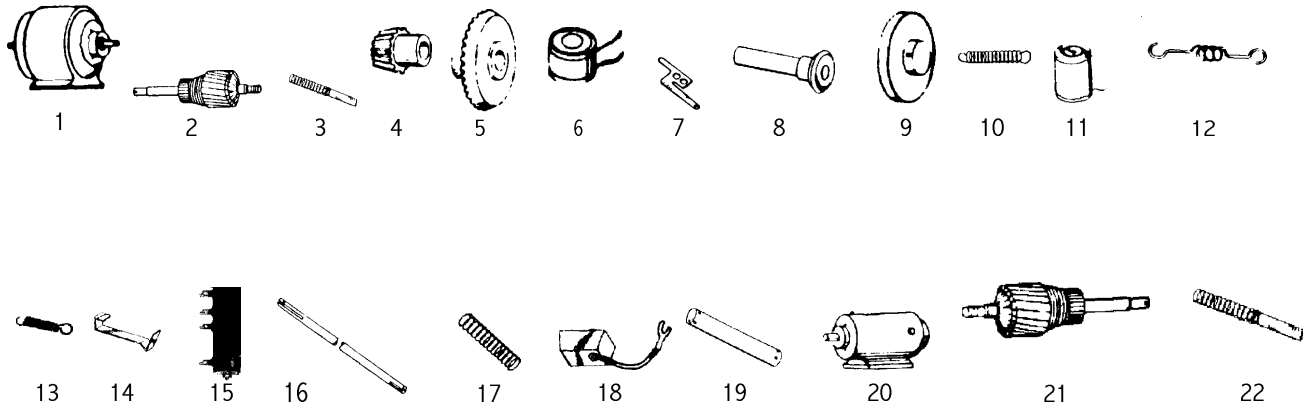

Ref No.	Skyview No.	Price (US Dollars)	Description
1	701	375.00	Feed Motor (\$200.00 Core)
2	708	150.00	Armature Motor (\$100.00 Core)
3	714	6.00	Feed Motor Brush (2 Required)
4	702	27.50	Gear Bev. Steel (small)
5	705	95.00	Gear Bev. Teflon (large)
6	710	30.00	Negative coil Feed & Retract
7	711A	7.50	Point
	711B	15.00	Points Positive Contacts Set (2)
	711C	22.50	Points Negative Contacts Set (3)
8	712	30.00	Negative Hand Control Tube
9	713	40.00	Clutch Neg. Drive Disk
10	716	5.00	Positive Spring
11	717	75.00	Coil Positive Feed
12	718	3.00	Spring Current Relay
13	719	3.00	Spring Positive Cam
14	721	6.00	Spring Negative Crank Clutch
15	722	37.50	230 ohm Resistor
16	801	37.50	Shaft Drive (specify Length)
17	803	3.00	Spring, Shaft
18	812	27.50	Brush Slip Ring (4 required)
19	805	8.50	Shaft coupling Bakelight
20	814	200.00	Blower Motor (\$150.00 Core)
21	815	150.00	Blower Motor Armature (\$100.00 Core)
22	5869390ABG1	9.00	Brushes Blower Motor (2 required)
	TM5-7111	60.00	GE Operating Manual (Searchlight)
	TM5-7112	80.00	GE Parts Catalog (Searchlight)
	TM5-7113	180.00	GE Maintenance Manual (Searchlight)
	TM SET 7111-7113	290.00	Complete set of all three Above

Copyright 1997 by National Event Marketing, Inc. Reproduction in whole or part is forbidden without the written consent of National Event Marketing, Inc.

All Prices subject to change without notice

**National Event Marketing, Inc. d.b.a. Skyview Company**  
**2810 Thousand Oaks, Suite 237, San Antonio, Texas 78232**  
**Web: www.sky-view.com E-Mail: sales@sky-view.com**  
**Phone (USA): 800.562.8439 Phone (International): 011.95.210.681.8500**